

## Usage:

1. Insert the LG-T2 bracket (Bought additionally) into the bottom of the light (Pic.1), push the light until the middle position and then tight all fixing screws (Pic.2)



(Pic. 1)



(Pic. 2)

2. Ensure the power of LED light is at off position, and then connect the power adapter, when the green light indicator is on, then switch on the light, and it could be used. This lighting is suitable for photo and video on full view light supplement.

## Precaution:

1. Please check after receiving the light, if any damage on LED Studio Light caused by transportation. If there is damage, please do not use the light and contact with distributor or the manufacturer ASAP.
2. Please do not mount the light directly on the surface of the common combustible material. Keep the light dry and keep it away from wet, hot or dusty condition, prevent the light from water or other liquids.
3. Before installation, please make sure the power voltage you use should be according to the voltage indicated on the lamp, please do not open and repair the lamp yourself when the power is connected.
4. Please do not use the power cord which is with bad insulating layer, and do not pull the plug or drag the power cord directly.

# LG-E60 LED STUDIO LIGHT

## Instruction Sheet



- The lighting comes with accessories together, pls check carefully.

| Name              | Quantity | Unit | Remarks |
|-------------------|----------|------|---------|
| Instruction sheet | 1        | PC   | English |
| Power adapter     | 1        | PC   | 15V     |
| Power cable       | 1        | PC   |         |

## LEDGO TECHNOLOGY LIMITED

Add: Zhanglin Section, Highway 324, Dongli, Chenghai, Shantou City, Guangdong Province, China  
 Tel: 0086-754-85354187 Fax: 0086-754-85300887  
 E-mail: info@ledgo.hk http://www.ledgo.hk

[www.ledgo.hk](http://www.ledgo.hk)

## Parameters:

Led Light Total power: 12W  
Power Supply Source: DC 10V-18V / AC100V-240V  
Color temperature: 5600K  
Ra: 95

## Components:

LED mounting board

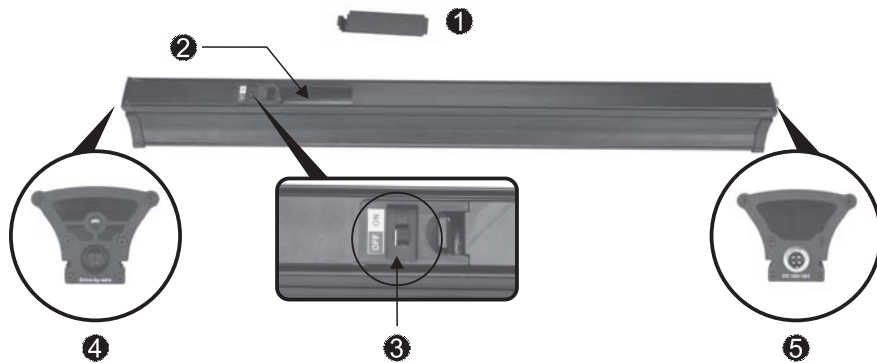

① Battery Cover: To prevent the Lithium battery falling from the battery holder.

② Battery Holder: For installing 3 pieces of 18650 Lithium battery.

③ Power Switch: To switch on or off.

④ Power Supply & Signal Control Interface:  
For connecting another light or inputing the remote dimming signal.



⑤ Power Supply & Signal Control Interface:  
For input of DC power supply or connecting another light.



Interface definition:

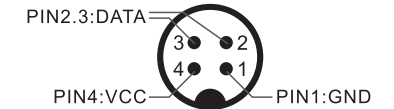
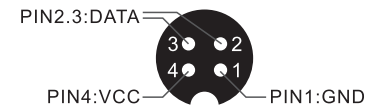

## Accessories



⑥



⑦

⑥ Power Cable: For connecting with power adapter to supply power.

⑦ Power Adapter: For connecting 100V-240V AC power.

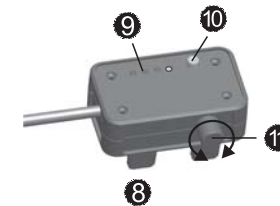

⑧ External Dimmer(bought additionally):Connecting the light signal port (indicated on the light) for dimming.

⑨ Indicator Light :For showing the power or brightness saturation.

⑩ Button for testing battery balance:When pressing the button,indicators will turn on to indicate the present power level.

⑪ Dimmer Knob:For stepless adjusting brightness.