

LG-2022L Chroma Key Background

Instruction Sheet

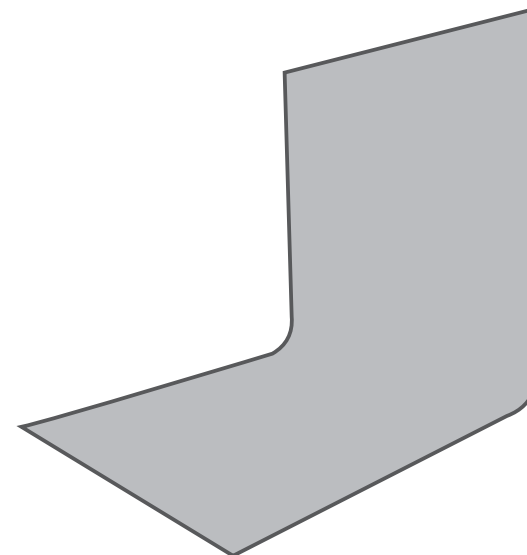
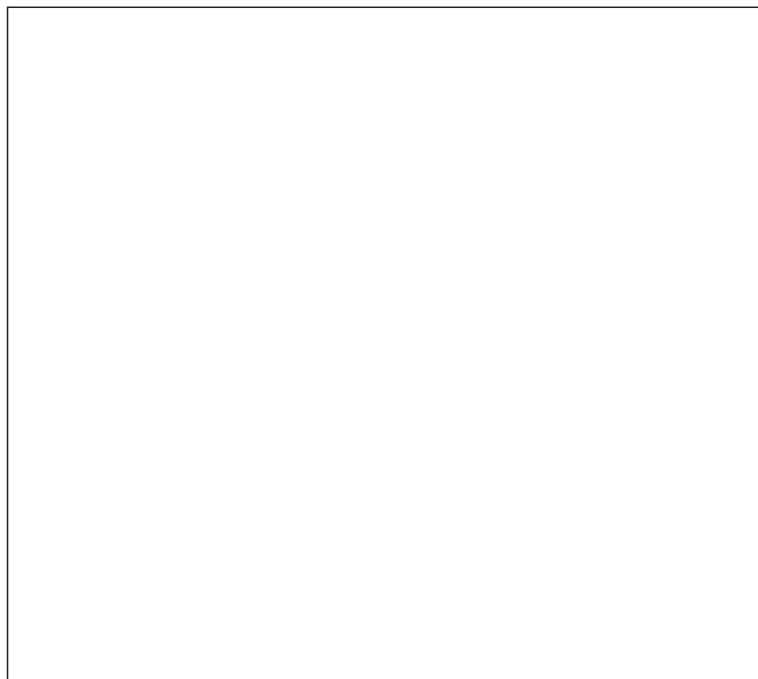

•The background come with accessories together, plc check carefully.

Name	Quantity	Unit	Remarks
Instruction Sheet	1	PC	
Splice joint	22	PC	Two-way: 12pcs Three-way: 6pcs Corner: 4pcs
Aluminium Tube	25	PC	
Cloth	1	PC	

LEDGO TECHNOLOGY LIMITED

Add:Zhanglin Section,Highway324,Dongli,Chenghai,Shantou City,Guangdong Province,China

Tel:0086-754-85354187 Fax:0086-754-85300887

E-mail:info@ledgo.hk <http://www.ledgo.hk>

www.ledgo.hk

1. Description

Instant green screen studio, an ideal spot for interview, speech, shoot, virtual studio; quick and convenient for building, can be built in 10 minutes, light weight, portable, easy to storage; green cloth, simple and clean, high resilience, no crease. Building size: 200 x 200 x 220 CM (WxDxH).

2. The installation diagram of LG-2022L background skeleton:

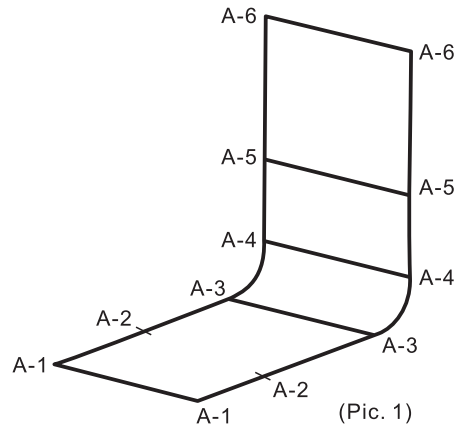

Steps as below:

- Pick out the unmarked aluminium tubes from the package 15 pcs and 10 pcs two-way connector (Pic.2), to match each two tubes (Pic.3) to become the three stops tube (as A-1~A-1, A-3~A-3, etc.), every tube have 3 parts, totally 5 pcs (Pic.4), pay attention to make sure the salient point could catch the small ring hole on the tube.

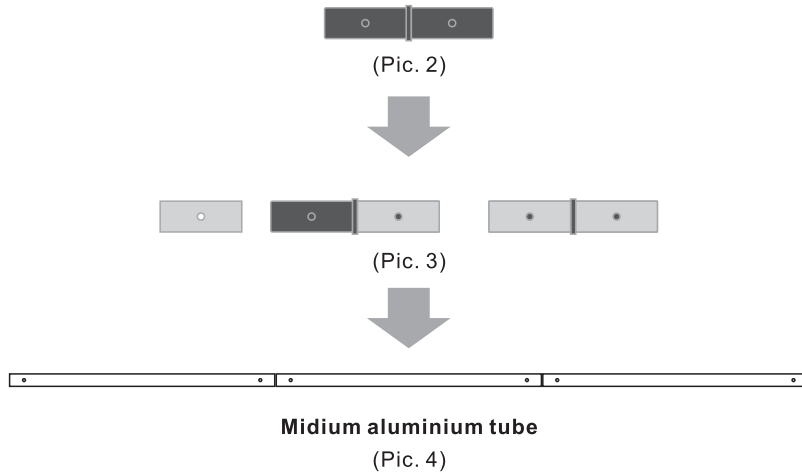

- Pick up the labelled aluminium tubes 10 pcs (There are similar labels of "A-X" on the tubes, and two of them are bend) and 6 pcs three-way head, 4 pcs corner (Pic. 7), 2 pcs two-way head. According to pic. 1, joint each same labels aluminium Tube with three-way connector (Refer to Pic.5, because "A-2" are at the bottom, so only joint them with two-way head is ok), during the jointing, the bend tubes on "A-3~A-4", that the direction should be the same when joint the three-way head. (Pic. 6), The positions of each two top angle "A-1" and "A-6" are jointed by corner, finish the right/left side jointing, take 5 pcs three stops tubes which finished at Step ① to joint each two tubes on the right and left side, finally finish as Pic. 1 showed.

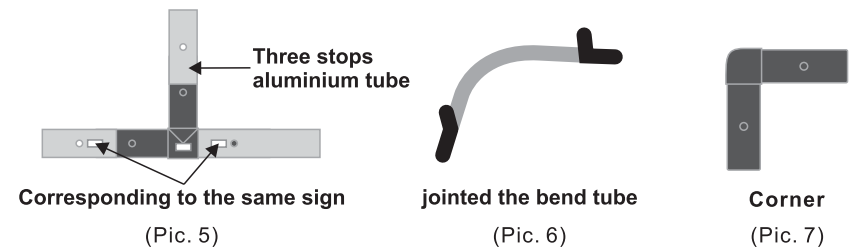

- Install the opening side of background cloth (Pic.8) from the position of the "A-6~A-6" to "A-1~A-1", and then using the velcro to post tight (After complete the installation, the label is on position of A-6), and leave the seal at the back of background. [The background cloth has resilience, if you find the cloth can not be set up, please do some stretch to finish it.]

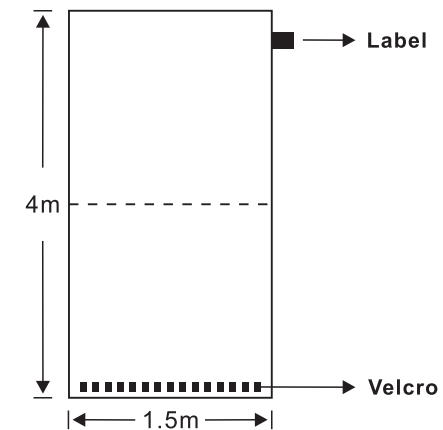

The expanded view of background cloth
(Pic.8)